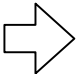

## Notes on Replacement of ROBONET Controller with R-unit

Please be advised of the following notes for replacement.

- In accordance with the order stop of ROBONET controller (RGW/RPCON/RACON/RABU)
  - ROBONET controller (RGW/RPCON/RACON/RABU) will be replaced with R-unit.

(Order stop) ROBONET controller (RGW/RPCON/RACON/RABU)		(Replacement model) R-unit
--	---	-------------------------------

- \* The motor/encoder cable has to be changed.
- \* Among the operation modes, solenoid valve mode 1 and 2 are not available after the replacement.
- \* The maximum number of positioning points of positioner 1 and 2 modes will change to 128 from 768.

**The details of notes are as follows.**

## Notes (details)

### 1. External dimension / installation dimension

The external dimensions of ROBONET controller and R-unit are different.

<ROBONET controller>

■ RGW (GateWayR unit)

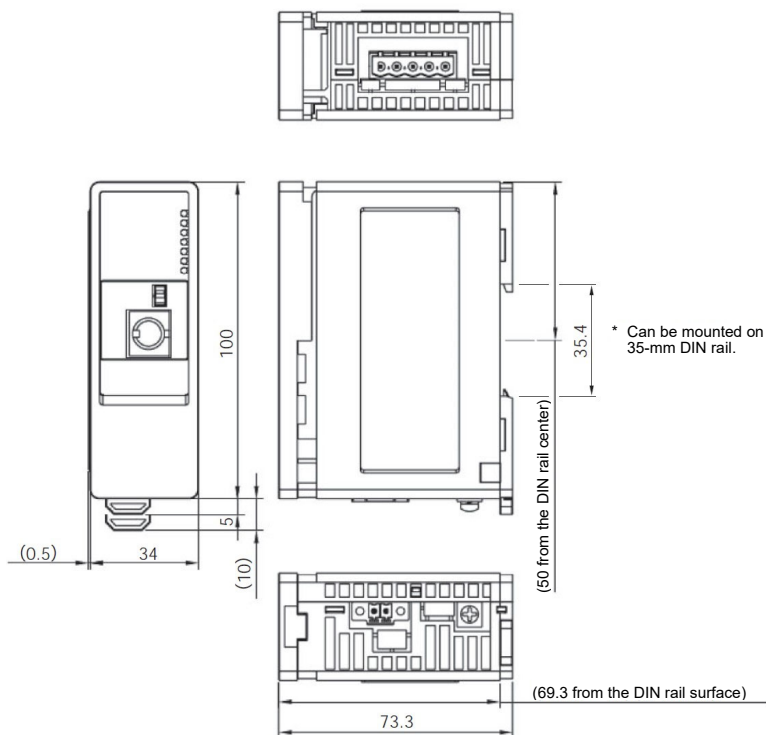

■ RACON/RPCON (controller unit)

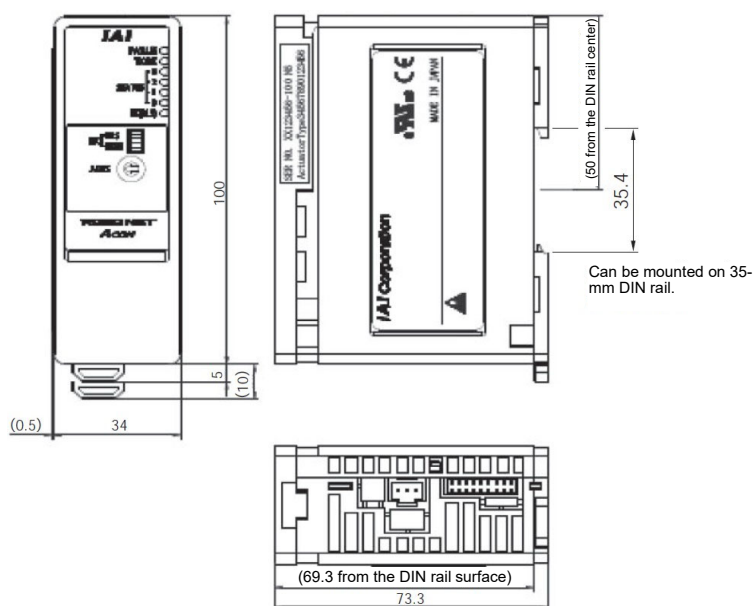

■ RABU (simple absolute R unit)

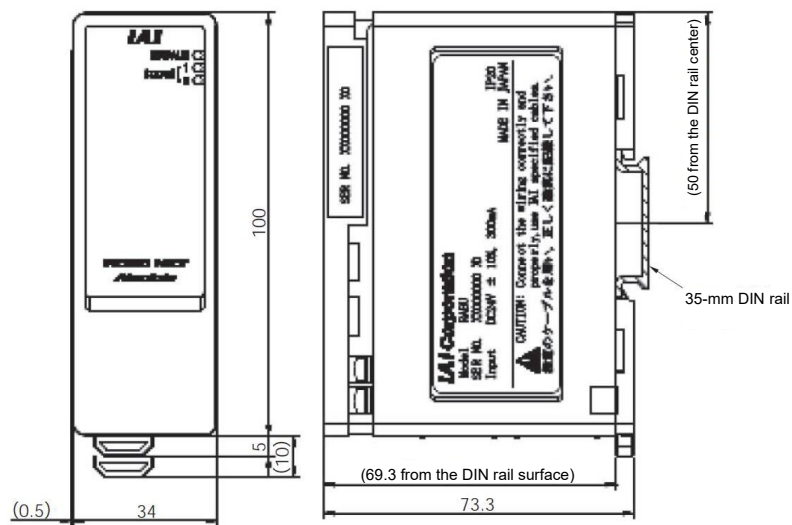

<R-unit>

■ RCON-GW (gateway unit)

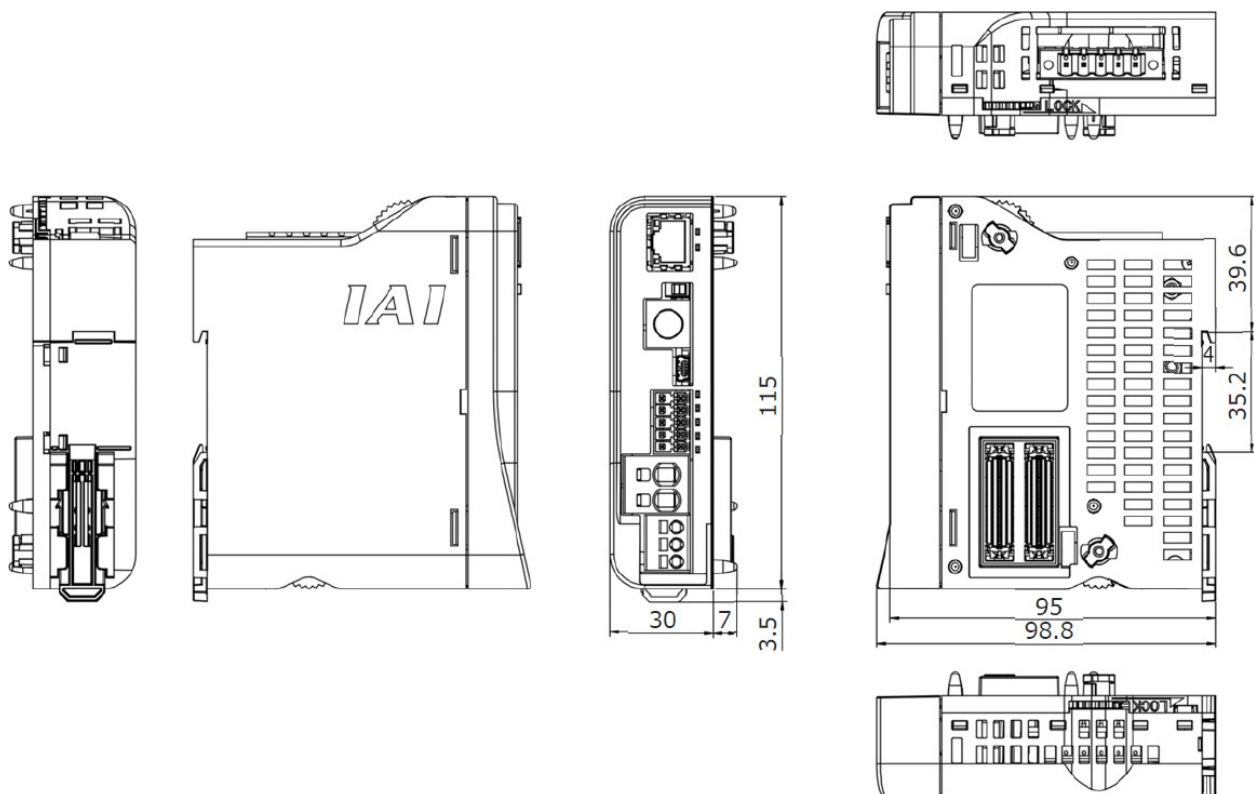

■ RCON-PC/AC (24-V driver unit)

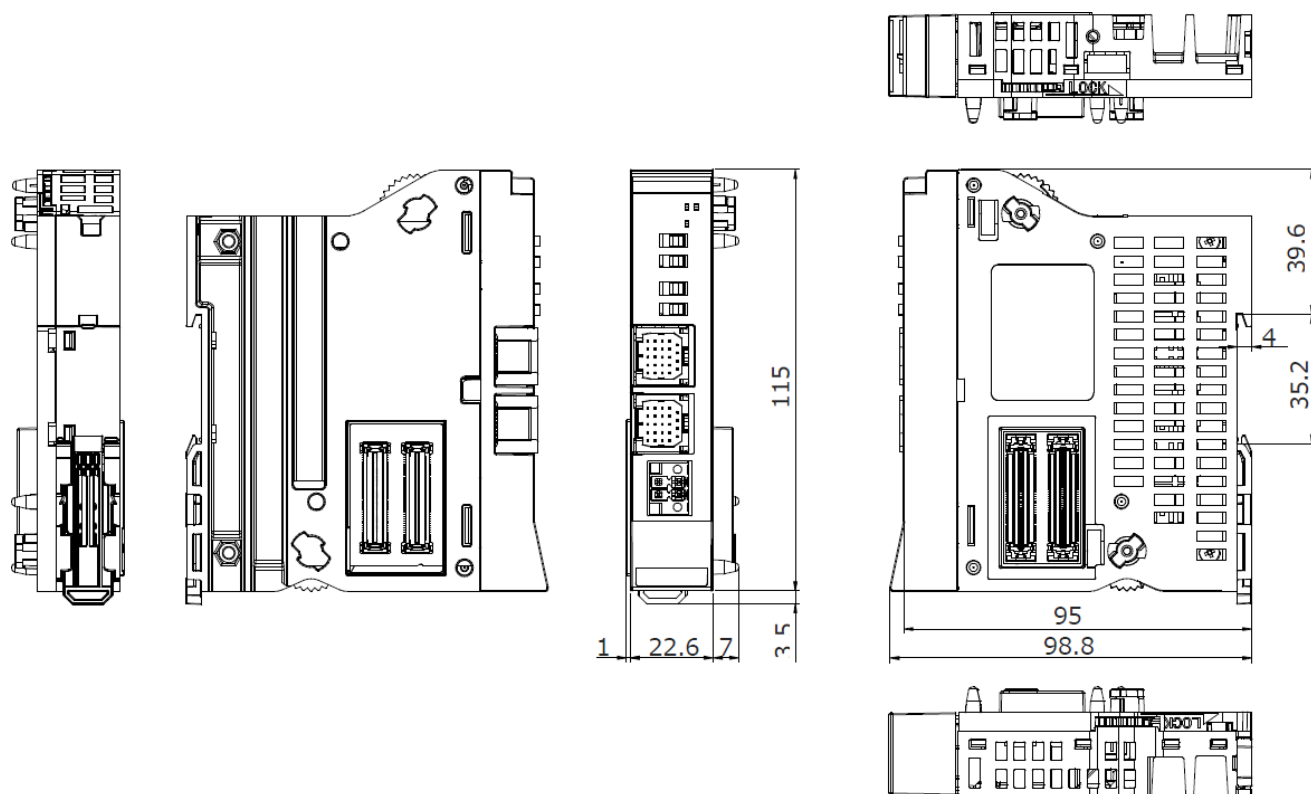

■ RCON-ABU (simple absolute unit)

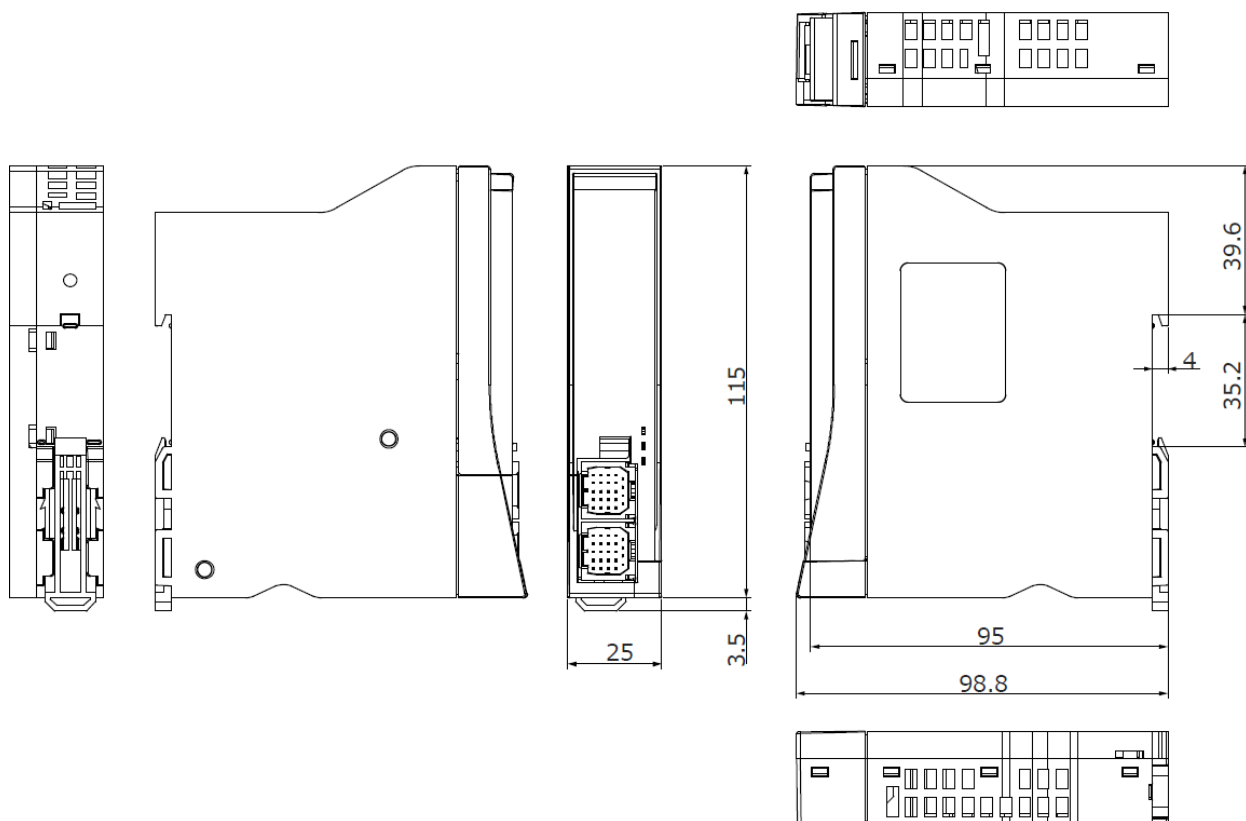

## 2. General specifications

Item	Discontinued model	Replacement model
	ROBONET controller	R-unit
Power-supply voltage	24 VDC $\pm$ 10%	24 VDC $\pm$ 10% 200 - 230 VAC $\pm$ 10%
Number of connectable axes	1 to 16 axes	1 to 16 axes
Connectable actuator	<RPCON> RCP2, RCP3 series	<RCON-PC> RCP2, RCP3, RCP4, RCP5, RCP6 series
	<RACON> RCA, RCA2, RCL series	<RCON-AC> RCA, RCA2, RCL series
Supported field network	CC-Link, DeviceNet, PROFIBUS, RS485SIO	CC-Link, CC-Link IE Field, DeviceNet, EtherCAT, EtherNet/IP, PROFIBUS-DP, PROFINET IO
	-	<Motion> EtherCAT motion, MECHATROLINK-III, SSCNET III/H
Operation mode	Direct numerical specification mode Simple direct numerical mode Positioner 1 mode Positioner 2 mode Solenoid valve mode 1 Solenoid valve mode 2	Direct numerical specification mode Simple direct numerical mode Positioner 1 mode Positioner 2 mode Positioner 3 mode Positioner 5 mode
SIO interface	RS485	RS485 / USB / EterNet (option)
Installation method	Installed on DIN rail (35 mm)	Installed on DIN rail (35 mm)

## 3. Control by serial communication

Serial communication port RS485 is common to all controllers.

\* R-unit is standard equipped with USB port and can be optionally equipped with EtherNet port.

#### 4. Motor/encoder cable

The connector shape of controller will be different.

If necessary, another cable, additional cable or conversion unit has to be purchased.

Current model	Replacement model
CB-RCP2-MA□□□ CB-RCP2-PB□□□ (-RB)	CB-PSEP-MPA□□□ RCM-CV-APCS (conversion unit) CB-ADPC-MPA□□□ (-RB)
CB-PCS-MPA□□□	CB-RCAPC-MPA□□□ (-RB)
CB-PCS2-MPA□□□	CB-ADPC-MPA□□□ (-RB)
CB-ACS-MA□□□ CB-ACS-PB□□□ (-RB)	CB-APSEP2-MPA□□□ RCM-CV-APCS (conversion unit) CB-ADPC-MPA□□□ (-RB)
CB-ACS-MPA□□□	CB-RCAPC-MPA□□□ (-RB)

#### 5. Various internal data

(1) Parameter

The parameters are not compatible.

When a controller is purchased, the parameters for the actuator to be connected shall be set.

(2) Position data

The position data is not compatible.

#### 6. Data input tool (teaching box/PC software)

The data input tool is common to all controllers.

(1) Teaching box

- TB-02 (recommended model)



## (2) PC software

### ■ IA-OS (recommended software)

Teaching software exclusively for PC (exclusively for Windows)

- Feature Startup support software with functions such as position input, test run and monitoring.  
With enhanced functions necessary for adjustment, startup time can be saved.
- Model **IA-OS** (Software only, for customers who already have dedicated connection cable)
- Standard price **80 USD** (For compatible versions, refer to our website.)
- Configuration

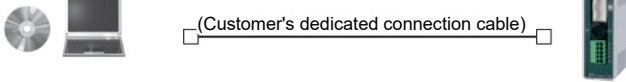

Compatible Windows: 7/10



## 7. Function/performance improvement

- (1) Various actuators (RCP series, RCS4 series, ISB series, NSA series, etc.) can be connected.
- (2) Compatible with battery-less absolute encoder equipped products
- (3) High performance, ultra mini size and more user friendly
- (4) Enhanced preventive/predictive maintenance function
- (5) Enhanced monitoring function

## 10. Contact

Should you have any questions, please feel free to reach us to the following contact numbers.

Thank you.